

Recently Completed Projects



Hong Kong Children's Hospital

The Hong Kong Children's Hospital is located in the South apron of Kai Tak Development. It comprises two 11-storey tower with a total construction floor area of 168,000 sqm. The hospital provides in-patient and day-patient services with 468 beds, 12 operating theatres, a cardiac catheterisation laboratory, clinical pathology and research laboratories. The overall design objective is to create a non-institutional home-like and child friendly environment.

Hong Kong Children's Hospital has been awarded:

1. ArchSD Annual Award (2017)
2. GBA - Merit Award, New Building Category
Project under construction and / or Design – Institution Building (2016)
3. BEAM Plus Platinum (PA) Provisional Rating (2016/17)

China Unicom (Hong Kong) Global Center

The Data Centre comprises 3 major operation centres, namely Global Solution Support Centre (APAC Countries), International Innovative Service System Centre and Cloud Computing and IoT R&D Centre. The total GFA is 37,000 sqm with 16 Data Halls. The mission critical MEP (including HV genset, 12 hour fuel storage) infrastructure is designed to house over 4,000 IT racks and the Data Centre was Uptime Institute certified with an on-site 132KV substation.

China Unicom (Hong Kong) Global Center has been awarded:

1. Lu-Ban Award (2017) - Overseas
2. USGBC – LEED Gold (2017)
3. Uptime Institute - Tier III Certification of Design Documents
4. Uptime Institute - Tier III Certification of Constructed Facility

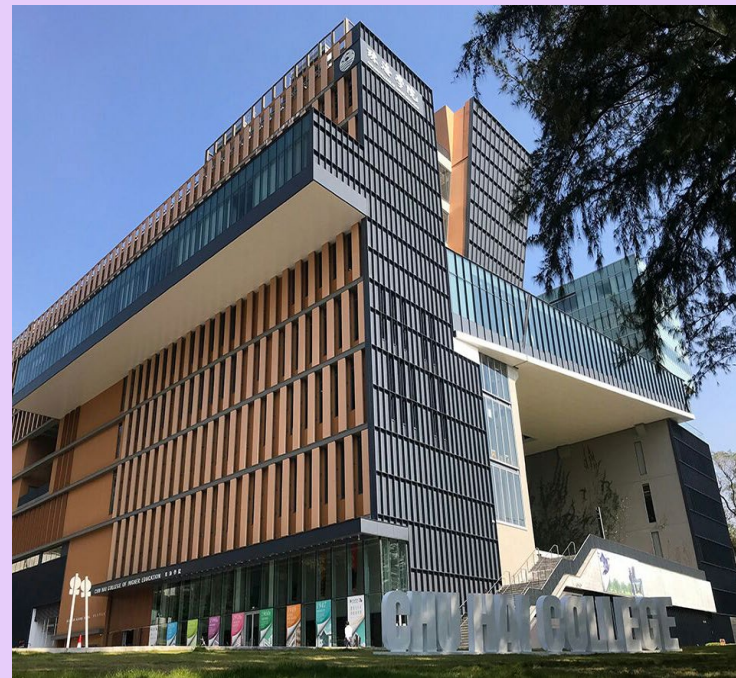
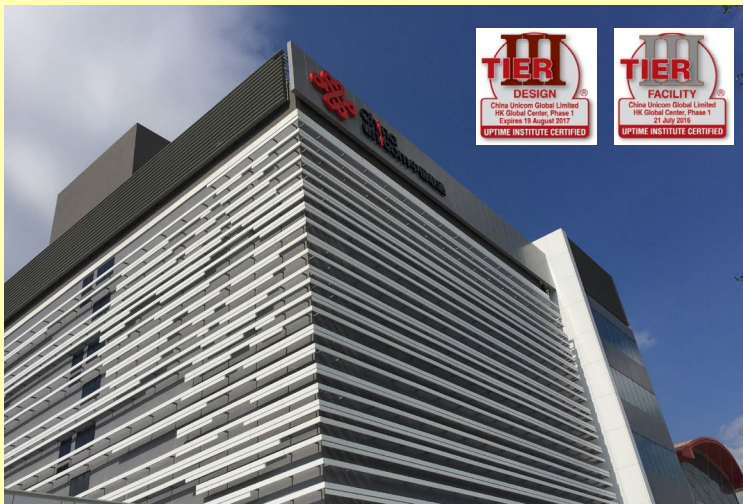

Chu Hai College New Campus

The new campus is located at Tuen Mun East, facing Castle Peak Bay. The project, with 33,000 sqm GFA, consists of staff quarters, student hostel, staff and administrative office, architectural and structural laboratory. The bridge between two blocks houses the library and student union. Indoor sports hall is located at ground floor of the building with full size basketball court. Under floor trunking is provided for all class rooms.

Chu Hai College New Campus has been awarded:

1. HKIA Medal of the Year of Hong Kong (2016/17)



33 Tseuk Luk Street Office Building Redevelopment

The existing building (Hip Lik Industrial Building) in San Po Kong was demolished and redeveloped into a prestigious 20-storey commercial and office development, with top four F&B and 4 storeys of basement car-park. The total GFA is 22,832 sqm.



Century Link

The project comprises 5 blocks of 30-32 storeys residential towers providing 2,020 residential units. The total GFA is about 130,000 sqm.



Park Vista (Phase 1A) & Park Yoho (Phase 1B & 1C)

Park Yoho is located at Sha Po North. The project provides 3,200 residential units in 31 blocks of 12-15 storeys. Facilities include kindergarten, public transport terminus (PTT) and sports & recreation. The total GFA is about 220,000 sqm.



West Kowloon Law Court Building

The Law Court Building comprises the West Kowloon Magistrate Courts, Small Claims Tribunal, Coroner Courts and Obscene Articles Tribunal. Other facilities include chambers and library for Judicial Officers; offices for support staff; a centralized accounts office; facilities for Correctional Services Department, Social Welfare Department and Duty Lawyer Service and a press room.



Nam Cheong Station Overhead Development (Phase 1 completed in End of December 2017)

The project is a composite residential development providing about 214,700 sqm of residential gross floor area and 27,660 sqm of commercial gross floor area. It comprises 7 high-rise residential towers and 7 low-rise residential blocks with a provision of 3,313 flats located above a 3-level podium and 2 level of basement carpark.

Projects under Design / Construction

One Taikoo Place (1TP)

It is a redevelopment project by Swire Properties which will further elevate Taikoo Place's status as a world-class commercial hub. A key highlight of the redevelopment is to build a super Grade-A office tower, each spanning a gross floor area of 93,000 sqm. "One Taikoo Place", is expected to be completed in Q3 2018. 1TP will be linked to the existing office towers in Taikoo Place by elevated, air-conditioned walkways and surrounded by landscaped gardens with cascading water features and alfresco dining areas. Additional outstanding features will include the creation of "Taikoo Square" and "Taikoo Garden", which will provide a total of 6,410 sqm of open space for the enjoyment of the community.

New Joint-user Government Office Building in Cheung Sha Wan

The office accommodation is for the re-provision of five bureaux and departments accommodated in the three government office buildings at Wan Chai waterfront. These include the Labour Department, the Registration and Electoral Office and Hongkong Post's Cheung Sha Wan Delivery Office. A general out-patient clinic, a 100-place child care centre, a 40-place day care centre for the elderly and a convenient store will be included in this project.

The net operational floor area is approx. 23,600sqm. The project is expected to be completed by the end of August 2023.



The BOT is a comprehensive development which comprises 92-storey of office, retail and services apartment. The building height is 396m and total GFA is 242,083 sqm (above ground) and 125,151 sqm (below ground).

The Chinese University of HK (CUHK) Medical Centre

The CUHK Medical Centre is wholly-owned by CUHK. The hospital provides a full range of medical services and serves as a key base for clinical research, healthcare education and training. The aims are serving the people of HK, enhancing the quality of teaching and research, and contributing to the healthcare system of HK.

The CUHK Medical Centre will cover a total construction floor area of 100,000sqm and will provide around 600 beds. It is expected to be completed by the first quarter of 2020 and start operation in the second quarter. The hospital is conveniently located next to the MTR University station and the public transport interchange.

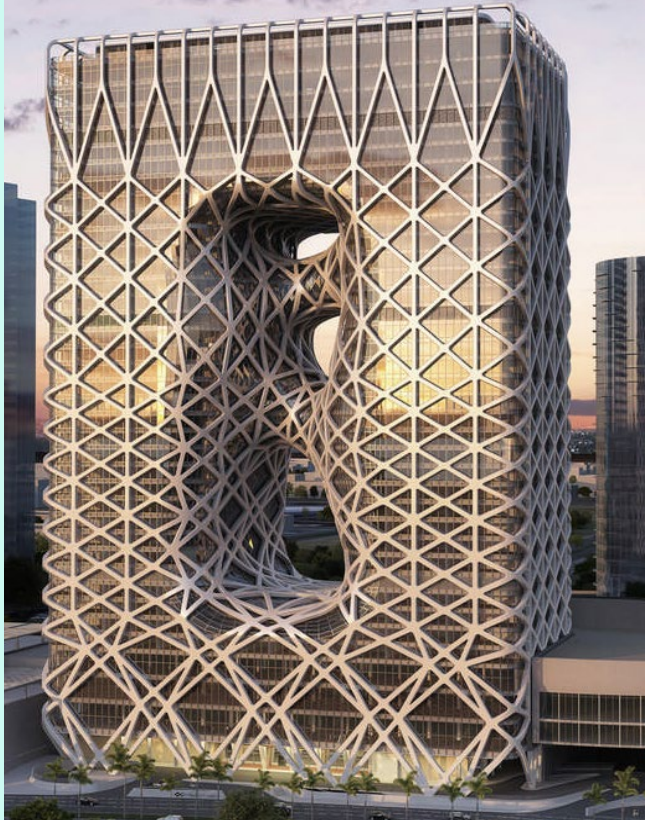

**Morpheus, City of Dreams
Cotai, Macau**

The Morpheus is the fifth hotel tower at City Dreams, Melco Crown Entertainment's flagship property in Cotai, Macau.

With 40 floors and a gross floor area of 150,000 sqm, the tower houses approximately 780 guestrooms, suites and sky villas. The hotel also includes a variety of meeting and event facilities, gaming rooms, lobby atrium, restaurants, spa, and sky pool. Integrating extensive back of house areas and supporting ancillary facilities.

The rectangular outline of the site is extruded as a monolithic block with a series of voids which carve through the centre of the tower, merging traditional architectural elements of roof, wall and ceiling to create a sculptural form that defines many of the hotel's internal public spaces.



**Commercial / Office
Development at NKIL 6572
Wing Hong Street, Cheung
Sha Wan, Kowloon**

The project is a single block Office / Commercial building, which comprises 26 storeys of office, office clubs, recreation facilities, VIP lounge, Sky Garden, Retail, Restaurants and 4 to 5 levels of basement carpark, refuge floor and E&M floors. The total GFA is about 34,476 sqm.

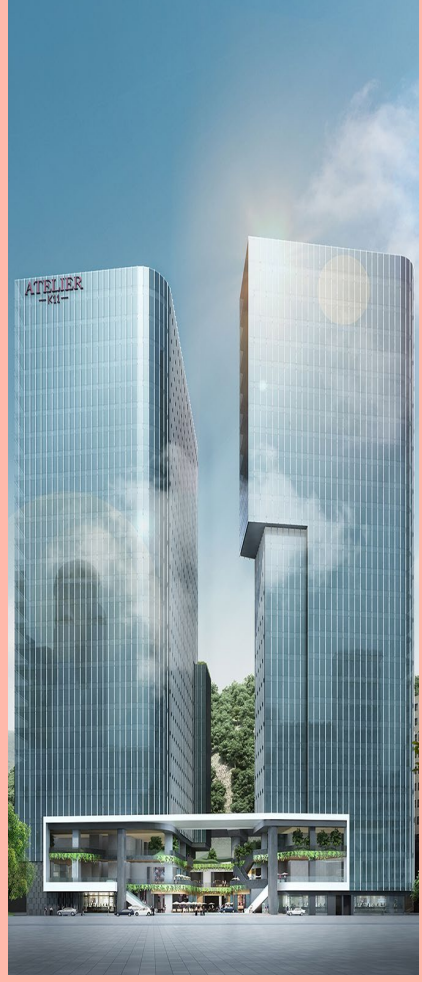

**Commercial Property
Development at NKIL
655, King Lam Street,
Cheung Sha Wan,
Kowloon**

The project comprises 2 blocks of Office / Commercial buildings with 24 storeys of office / retail in each block and 3 levels of basement carpark with E&M plant rooms. The total GFA is approx. 92,736 sqm.



**West Kowloon Government Office Building
in Yau Ma Tei**

The project comprises the design and construction of the West Kowloon Government Office Building, which is located in Yau Ma Tei not far away from Olympic City, Tai Kok Tsui. The total NOFA is around 50,500 sqm. It will be developed into 2 buildings of 15 to 18 storeys with a common basement for car parking, plant rooms and BOH facilities. The 2 buildings will provide office accommodations for BD, TD, CEDD, LandsD, GPA, SWD, DH, LCSD and EMSD workshops / stores.

J. ROGER PRESTON LIMITED

Level 11, Tower 1 Millennium City 1, 388 Kwun Tong Road, Kowloon, Hong Kong

• T (852) 2590 9333 • F (852) 2590 9897 • E info@jrp-group.com • www.jrp-group.com



HONG KONG | BEIJING | SHANGHAI | SHENZHEN | MACAU | SINGAPORE | KUALA LUMPUR | HO CHI MINH CITY